

## EFFICIENT LIGHTING SOLUTIONS

**AL-CCA Series**
**Wet Location LED Corncob Lights**

**Features**

- Aluminum fin-shape heat sinking and active air exchanging cooling system to speed up cooling process
- Approved for enclosed fixtures, base-up applications
- Very low energy consumption, low thermal output
- Popular, ballast free, easy installation, 120-277V Operation
- Not suitable for dimmers
- Can be easily fitted instead of ordinary bulbs
- **Remove ballast before installing**
- Can be used in enclosed fixtures
- UV (Ultra-Violet) and IR (Infra-Red) free
- 100% mercury free

**Applications**

- Garage Lighters
- Parking lots
- Factories
- Supermarkets
- Schools
- Offices
- Canopy Lighting
- Public applications

**Certifications**

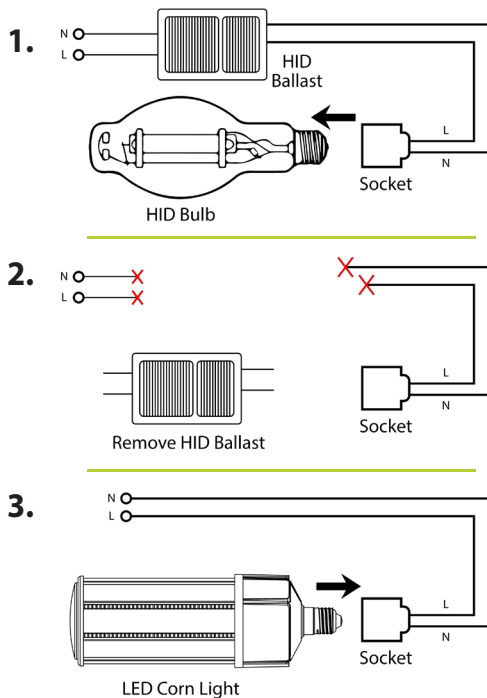
**Wiring Diagram**

**Fixture Details**

Model Name	AL-CCA-30W	AL-CCA-60W	AL-CCA-120W
Power Consumption	30 watts	60 watts	120 watts
Luminous Efficacy	110 lm/W	106 lm/W	130 lm/W
Luminous Flux	3,300 lm	6,400 lm	15,600 lm
Base Configuration	Mogul Base	Mogul Base	Mogul Base
Color Temperature	6000K		
Color Rendering	> 70 CRI		
Life Time Rating	50,000 Hours		
Input Voltage	120 - 277V		
Frequency	50 / 60Hz		
Operating Temp.	-4°F to 113°F		
Base	E40 Mogul Base		
Size (L x OD)	9" x ø3.5"	11.25" x ø3.5"	12.25" x ø5"
Weight	20.9oz. (593g)	25.8oz. (731g)	3 lb. (1.4Kg)
Replaces	175W HID	250W HID	400W HID

**Ordering Guide**

Series	Wattage	CRI	CCT	Base
AL-CCA	30: 30 watt 60: 66 watt 120: 120 watt	7: 70+ CRI	60: 6000K	MOG: Mogul

Adding an Abaco Lighting approved motion sensor system to your lighting upgrade project will further enhance energy savings and create an even faster payback. Specifications are subject to change with or without notice.