

AL-ES3V-MS Series
Value Line LED High Bay

Features

- Easy one-for-one replacement with existing fluorescent and HID fixtures
- 50% + Power Savings
- Provides excellent light distribution and uniformity.
- Long life LED solution ensures lower maintenance costs.
- Multiple mounting options available
- High-quality construction delivers 134+ lm per watt efficiency and excellent thermal characteristics.

Applications

- Manufacturing / Warehouse
- Factories
- Exhibition centers
- Airports
- Gymnasiums
- Sport arenas

Certifications

Fixture Details

Model Name	2 Module-Short	4 Module-Short	6 Module-Short
Power Consumption	50W	101W	151W
Luminous Efficacy	> 134 lm/W	> 135lm/W	> 135 lm/W
Luminous Flux	6,709 lm	13,563 lm	20,413 lm
Color Temperature	5000K		
Color Rendering	> 75 Ra		
Beam Angle	Symmetric		
Life Time Rating	> 200,000 Hours		
Input Voltage	100 - 277 VAC 347 / 480VAC		
Frequency	50 / 60Hz		
Operation Temperature	-31°F - 122°F (-35°C - 50°C)		
Size (L x W x H)	23-1/4" x 9-3/4" x 2-1/4"	23-1/4" x 14" x 2-1/4"	23-1/4" x 18-3/4" x 2-1/4"
Weight	8lbs (3.6Kg)	10lbs (4.5Kg)	14lbs (6.4Kg)
Body	Extruded aluminum		
Optic	White reflector		
Lenses	No lens, clear lens, frosted polycarbonate lens		
IP Rating	IP30		
Fixture Options	Dimming, occupancy sensor, emergency battery back-up, wire guard		
Mounting Options	Aircraft cable, pendant mount		

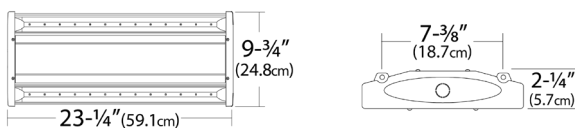
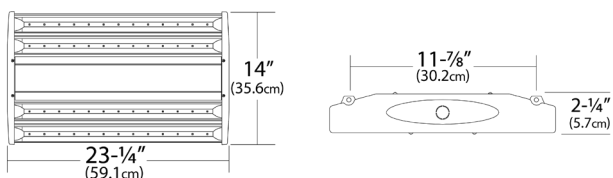
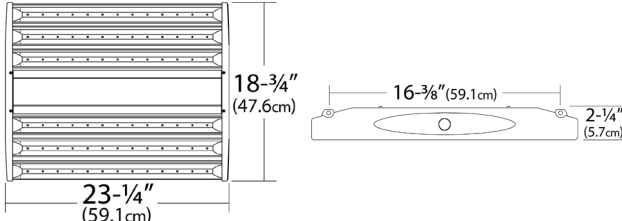
Dimensional Drawings
2 Module-Short

4 Module-Short

6 Module-Short

Ordering Guide

Series	Wattage	CCT	Lens	Driver	Options
AL-ES3V	2MS: 50W	5: 5,000K	NL: No lens	U: 120 - 277V HV: 347 / 480V	10V: 0-10V Dimming
	4MS: 101W		CL: Clear Lens		OCC: Occupancy Sensor
	6MS: 151W		FL: Frosted Lens		EMB: Battery Back-up WG: Wire Guard

Adding an Abaco Lighting approved motion sensor system to your lighting upgrade project will further enhance energy savings and create an even faster payback
 Specifications are subject to change with or without notice.